



**TRANSPORT AND TRAFFIC
CONSULTANCY**

Tel 07778 551690

*48 Church Gardens
Ealing
London W5 4HH*

Email info@transport-traffic.co.uk

**RESIDENTIAL AND COMMERCIAL DEVELOPMENT
219-223 COLDHARBOUR LANE,
LONDON SW9**

**OUTLINE CONSTRUCTION TRAFFIC
MANAGEMENT PLAN**

BY

C M VEASEY CMILT MCIHT

JUNE 2019

Transport and Traffic Consultancy is a trading name of The Transport and Traffic Consultancy Limited, a company registered in England.

Director: C M Veasey BSc DipTransP CMILT MCIHT

Registered Office: 48 Church Gardens, Ealing, London W5 4HH Registration No. 2995276 Vat Registration No. 649 9941 66

Purpose

1. The purpose of this outline Construction Traffic Management Plan is to provide an indication of the proposed measures to minimise the local traffic, parking and environmental impact of the construction traffic for this development.
2. A full Construction Traffic Management Plan will be prepared in conjunction with a Construction Method Statement for the development.

Materials Delivery and Spoil Removal

2. All delivery of materials and equipment to the site and removal of spoil and construction equipment will take place at the Hinton Road frontage using the existing vehicle access crossover which will be reinforced as necessary.
3. No delivery vehicles will enter the site, only vehicles/ machinery engaged in the construction process or transferring materials or equipment to/from delivery vehicles parked on the highway. Materials being delivered will be offloaded by crane or mobile transfer vehicle such as dumper. Spoil or other material being collected will similarly be transferred to the collecting vehicle on the highway.
4. All delivery vehicles will park at the nearside of the road, being routed to the site so as to make that possible, as outlined in the following section.
5. On Hinton Road, delivery/ removal vehicles will stand south of the site access crossover but north of and clear of the access crossover serving the adjacent premises at nos 1-9 Hinton Road.
6. Deliveries or spoil collections will be scheduled and controlled such that no more than one delivery or removal vehicle stands on Hinton Road at any time.

Construction Traffic Access Routes

7. Construction delivery and removal vehicle approach routes to the Hinton Road site access will be via Coldharbour Lane westbound from Camberwell, turning left into Hinton Road southbound, or from the A23 Brixton Road into Loughborough Road southeastbound to Hinton Road southbound. The more direct and major route from the west via Coldharbour Lane eastbound is not possible due to the banned right turn from Coldharbour Lane into Hinton Road.
8. The route for vehicles departing from the site will be via Hinton Road southbound, left into Wanless Road eastbound, left into Herne Hill Road northbound then left or right into Coldharbour Lane westbound or eastbound as appropriate.
9. It is recognised that Wanless Road is a predominantly (though not entirely) residential road but its use as part of the construction traffic

routeing for this development is necessary to minimise the overall traffic and environmental impact of the construction traffic. Construction traffic drivers will be instructed to exercise particular care and consideration when passing along Wanless Road and residents will be provided with contact information for the construction site management for use in the event of any complaints or concerns.

Hours of Operation

10. The normal hours of operation at the site will be
08:00 to 18:00 – Monday to Friday,
08:00 to 13:00 – Saturday

However special arrangements may be necessary for special construction events such as crane delivery/ removal or major concrete pours which may involve activity at and adjacent to the site outside these weekday hours or on Sundays, subject to agreement with the Council and the Police.

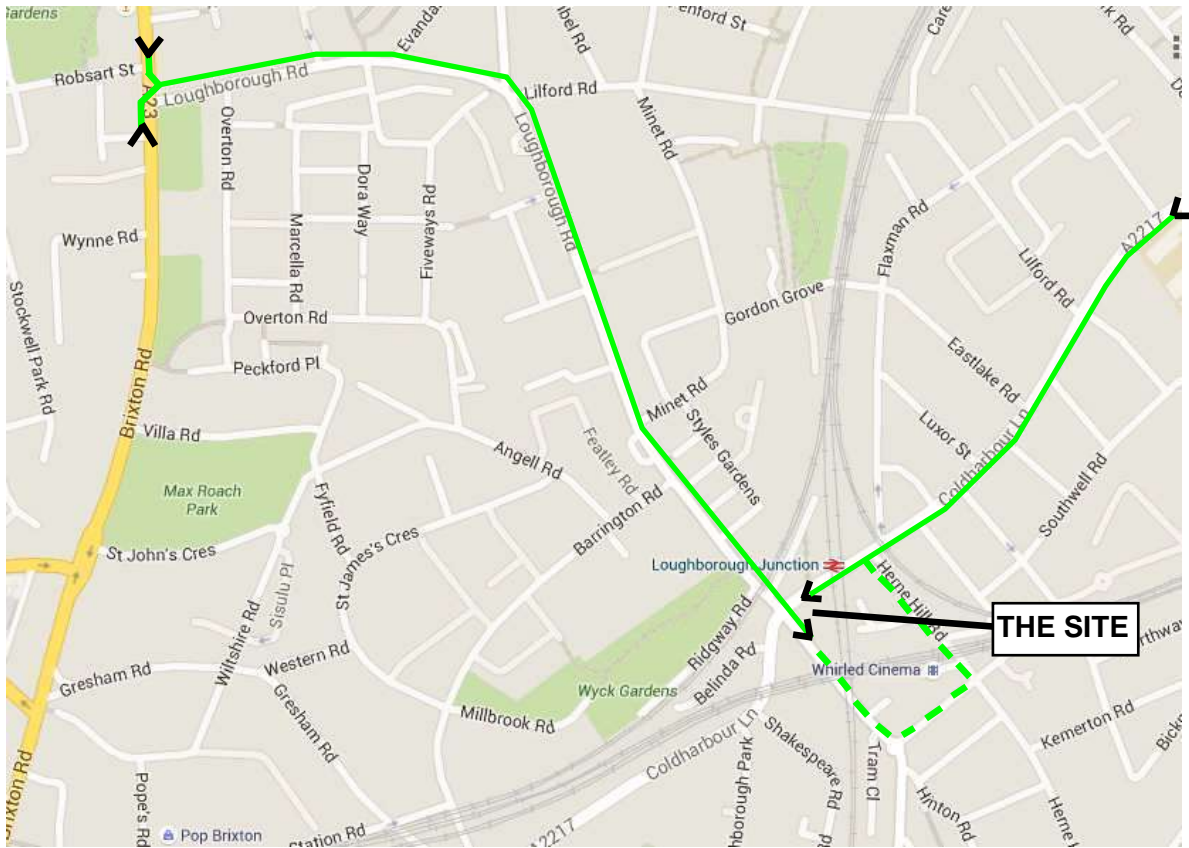

Construction traffic approach routes to site shown in green

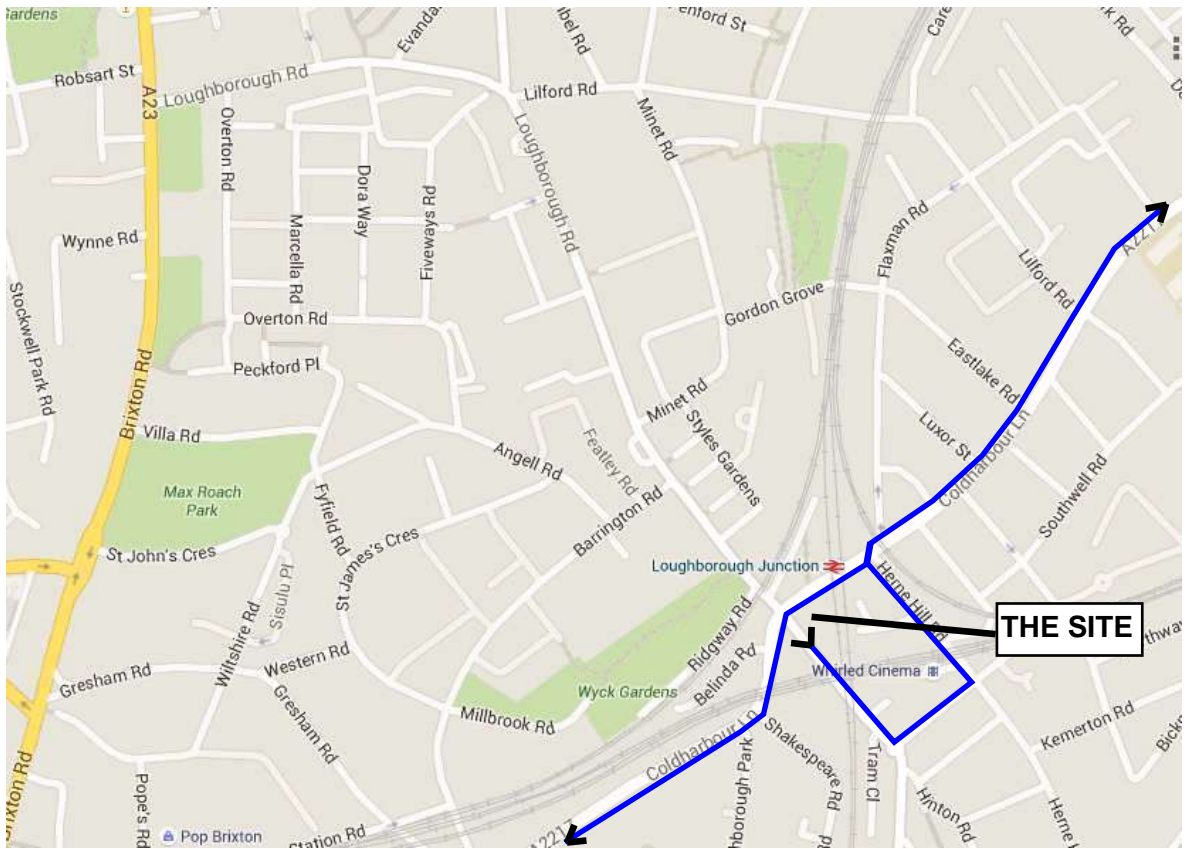

Construction traffic departure routes from site shown in blue

Construction traffic routes to and from site FIGURE 1

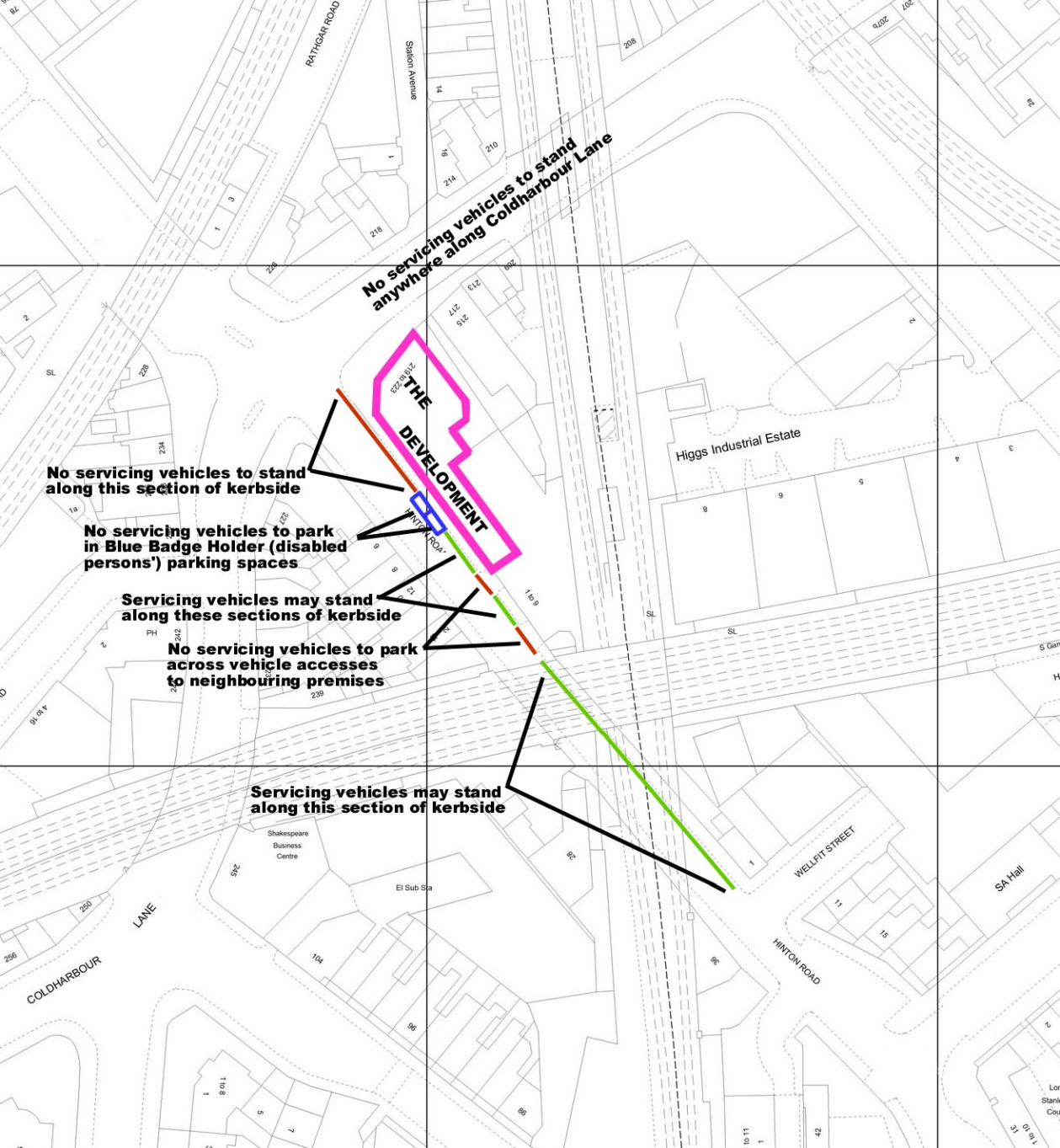

No servicing vehicles to stand anywhere along Coldharbour Lane

No servicing vehicles to stand along this section of kerbside

No servicing vehicles to park in Blue Badge Holder (disabled persons') parking spaces

Servicing vehicles may stand along these sections of kerbside

No servicing vehicles to park across vehicle accesses to neighbouring premises

Servicing vehicles may stand along this section of kerbside

THE DEVELOPMENT

Higgs Industrial Estate

Shakespeare Business Centre

El Sub Sta

WELFIT STREET

NINTON ROAD

SA Hall

COLDHARBOUR LANE

RATHBAR ROAD

Station Avenue

Lor Stanli Cou