

01. Copyright: This drawing must not be reproduced in whole or part without written consent from Vine Architecture Studio Limited
 02. All dimensions to be checked and any discrepancies to be reported to Vine Architecture Studio prior to construction
 03. Do not Scale from this drawing
 04. This drawing may contain information from other professions or third parties. Vine Architecture Studio cannot accept responsibility for the integrity or accuracy of such information.
 05. If in any doubt about the information in this drawing, ask Vine Architecture Studio without delay

Notes:

- This drawing is for planning purposes only

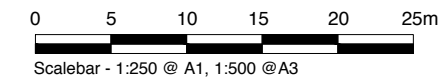
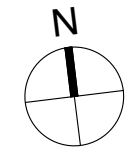
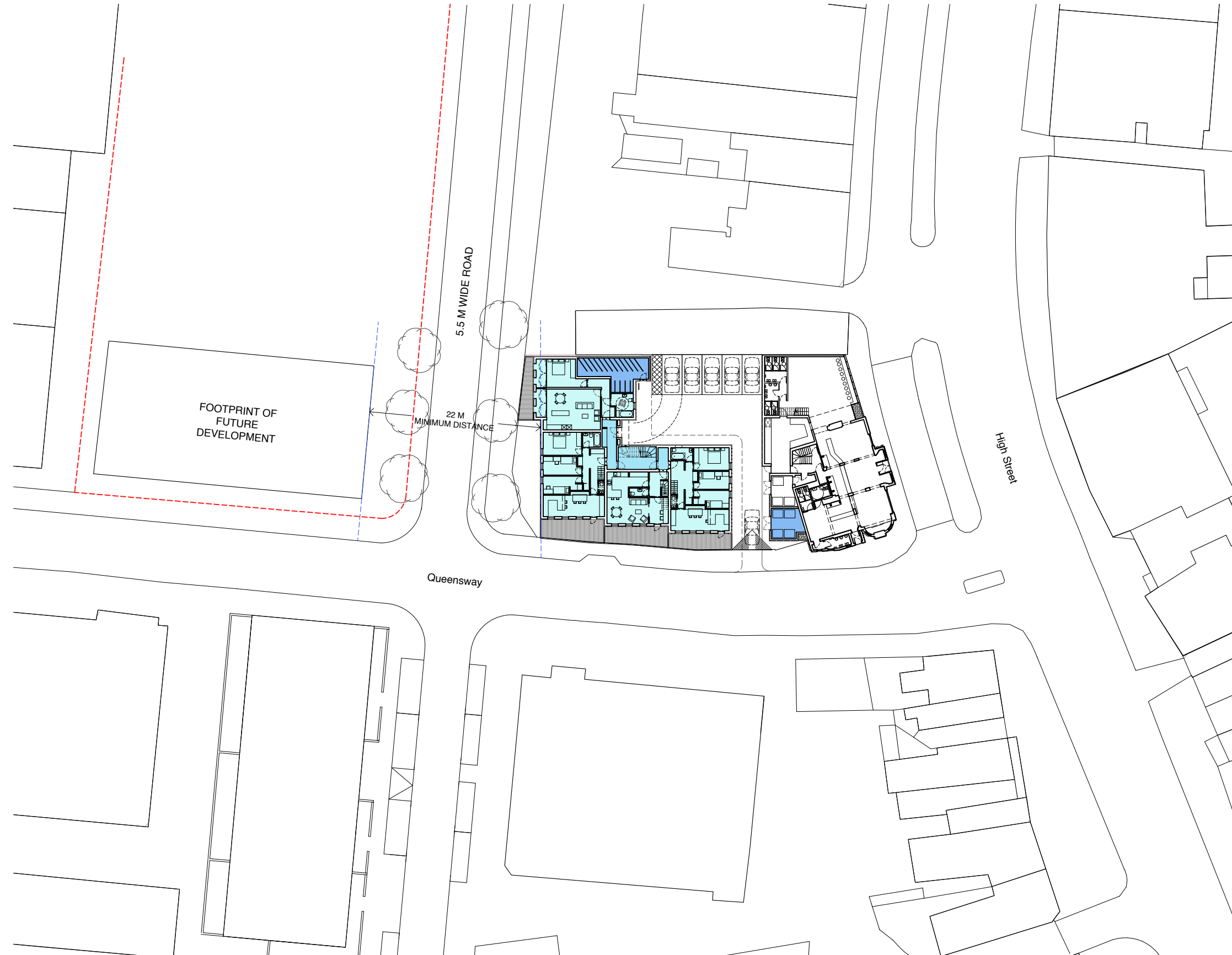

Revision	Description	Date
2	Full Planning Application	23/10/2019
1	Full Planning Application DRAFT	19/08/2019
*	Planning Application FINAL DRAFT	21/06/2019

Status <input type="radio"/> Pre-Planning <input checked="" type="radio"/> Planning <input type="radio"/> Tender <input type="radio"/> Construction <input type="radio"/> As Built		Vine / Architecture Studio <small>132 Whitechapel Road, London E1 1JE www.vinearchitecture.com studio@vinearchitecture.com T 0207 377 5465</small>
<input checked="" type="radio"/> Information <input type="radio"/> Discussion		

Client Name Ponders End Properties LTD			
Project Name Ponders End Housing		Project Number VINE92	
Date 23.10.2019	Scale 1:250 @ A1 1:500 @ A3	Drawn by PJ	Checked by RPR
Drawing Name Proposed Location Plan		Drawing No P/000	Revision 2

01. Copyright: This drawing must not be reproduced in whole or part without written consent from Vine Architecture Studio Limited
 02. All dimensions to be checked and any discrepancies to be reported to Vine Architecture Studio prior to construction
 03. Do not Scale from this drawing
 04. This drawing may contain information from other professions or third parties. Vine Architecture Studio cannot accept responsibility for the integrity or accuracy of such information.
 05. If in any doubt about the information in this drawing, ask Vine Architecture Studio without delay

Notes:

- This drawing is for planning purposes only



01 Proposed - South Site Elevation
 P/050 Scale 1:250@A1 1:500@A3

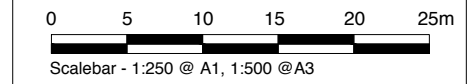

Revision	Description	Date
2	Full Planning Application	23/10/2019
1	Full Planning Application DRAFT	19/08/2019
*	Planning Application FINAL DRAFT	21/06/2019

<ul style="list-style-type: none"> <input type="radio"/> Pre-Planning <input checked="" type="radio"/> Planning <input type="radio"/> Tender <input type="radio"/> Construction <input type="radio"/> As Built <input checked="" type="radio"/> Information <input type="radio"/> Discussion 	<p>Vine / Architecture Studio</p> <p>132 Whitechapel Road, London E1 1JE www.vinearchitecture.com studio@vinearchitecture.com T 0207 377 5465</p>
---	---

Client Name
Ponders End Properties LTD

Project Name
Ponders End Housing

Project Number
VINE92

Date	Scale	Drawn by	Checked by
23.10.2019	1:250 @ A1 1:500 @ A3	PJ	RPR

Drawing Name	Drawing No	Revision
Proposed Site South Elevation	P/050	2