

01. Copyright: This drawing must not be reproduced in whole or part without written consent from Vine Architecture Studio Limited
 02. All dimensions to be checked and any discrepancies to be reported to Vine Architecture Studio prior to construction
 03. Do not Scale from this drawing
 04. This drawing may contain information from other professions or third parties. Vine Architecture Studio cannot accept responsibility for the integrity or accuracy of such information.
 05. If in any doubt about the information in this drawing, ask Vine Architecture Studio without delay

Notes:

- This drawing is for planning purposes only

KEY

- Site boundary

- Existing structures to be retained

- Later additions to be demolished

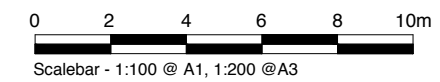
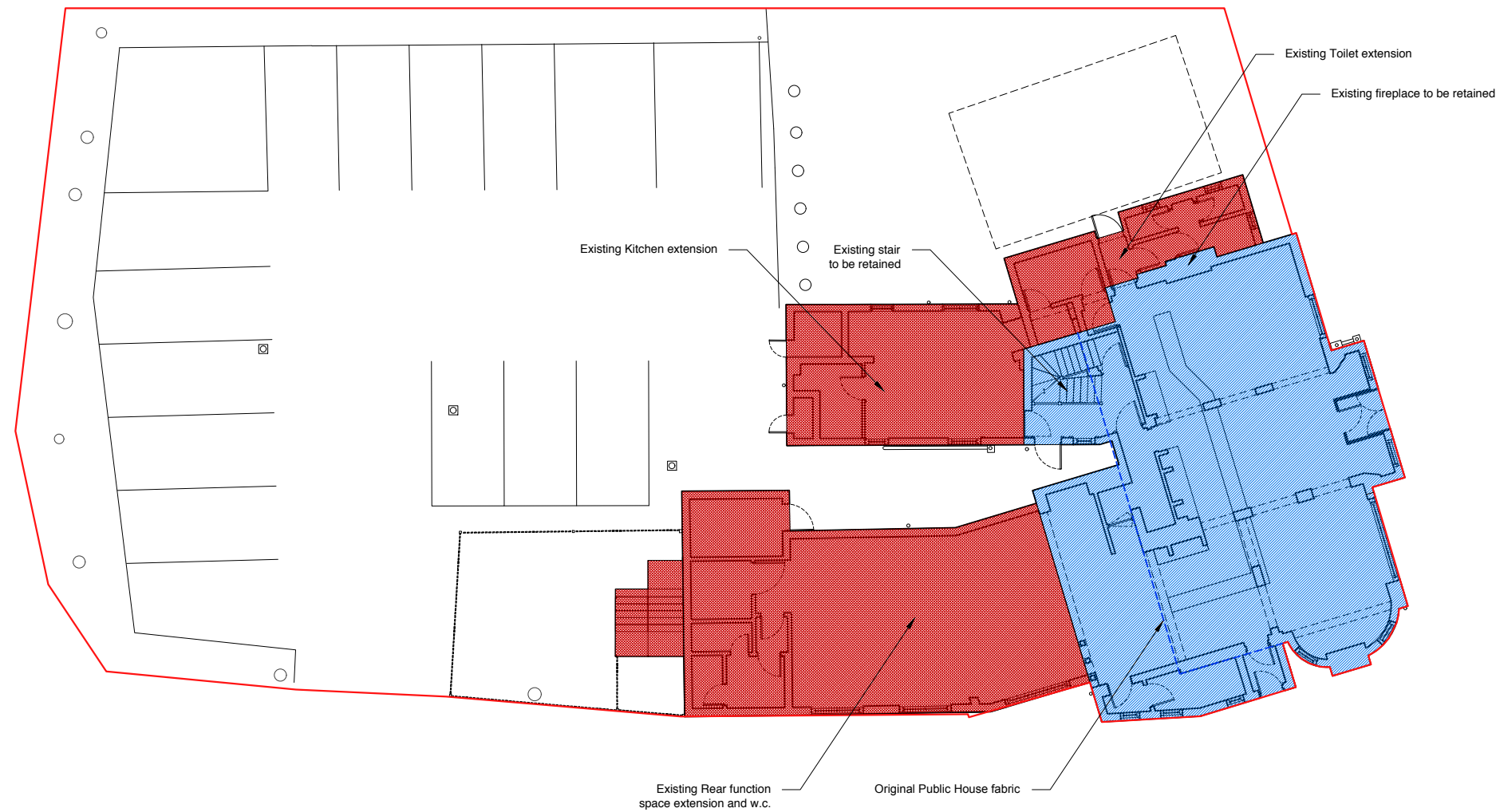

Revision	Description	Date
4	Full Planning Application	23/10/2019
3	Full Planning Application DRAFT	19/08/2019
2	Pre-Planning Application	21/12/2018
1	Pre-Application FINAL DRAFT	18/12/2018
*	Pre-planning DRAFT	12/12/2018

<p>Status</p> <ul style="list-style-type: none"> <input type="radio"/> Pre-Planning <input checked="" type="radio"/> Planning <input type="radio"/> Tender <input type="radio"/> Construction <input type="radio"/> As Built <input checked="" type="radio"/> Information <input type="radio"/> Discussion 	<p>Vine / Architecture Studio</p> <p><small>132 Whitechapel Road, London E1 1JE www.vinearchitecture.com studio@vinearchitecture.com T 0207 377 5465</small></p>
---	---

Client Name
Ponders End Properties LTD

Project Name Ponders End Housing	Project Number VINE92
-------------------------------------	--------------------------

Date 23.10.2019	Scale 1:100 @ A1 1:200 @ A3	Drawn by PJ	Checked by RPR
--------------------	-----------------------------------	----------------	-------------------

Drawing Name Demolition Ground floor Plan	Drawing No D/100	Revision 4
---	---------------------	---------------